

Star LED's SUN EATER solar luminaire is an all in one solution for efficient lighting in areas where power is unavailable or impractical to run. Versatile and sleek, the SUN EATER is available in 6 sizes, multiple lumen outputs and 3 standard optical distributions. Its innovative rotatable LED modules, bifacial solar panels and 25 year lifespan are industry leading. The optional accessories allow you to tailor your specifications and future proof your investment. All this backed by an industry leading 10 year limited warranty, now that is quality you can trust!

Model Guide		[Example Model: SE-50W-4K-T4-12-24V-DIM-SF-BG-BL]						
Series	Wattage	CCT	Distribution	Voltage	Sensor	Mount	Features	Finish
SE SUN EATER	10-15W 2000lm	3K 3000K	T2 (T203 Symmetrical)	12-24V DC (standard)	DIM Dimmable Microwave sensor (standard)	SF Slip Fitter (standard, to fit tenons of 2 3/8")	USB USB power input (optional)	BL Black (standard)
	20-25W 3800lm	4K 4000K	T3 (T304 Symmetrical)		MS Motion Sensor (up to 29ft)	WL Wall	4KV 4KV Additional Surge Protection Device (optional)	O Other / Custom (optional)
	30-35W 5880lm	5K 5000K	T4 (T402 Symmetrical)		PIR PIR Sensor (up to 22ft)	RPS Round, Post Side	ALM Alarm Device (optional)	
	40-45W 7680lm	5.7K 5700K				SPS Square, Post Side	SC Security Camera (optional)	
	50W 9600lm	6.5K 6500K					BG Bird Guard (optional)	
	60W 12000lm						APP Intelligent app controller (optional)	

Photometric Distribution Options

SUN EATERS standard lumen distributions are as per diagrams below. The luminaires unique, field adjustable LED modules have the versatility to be repositioned and tested during install allowing optimum placement for energy absorption. Photometric reports tailored to your specification and project, demonstrating suitable distributions and total lumen requirements are available, contact us for more information.

T2

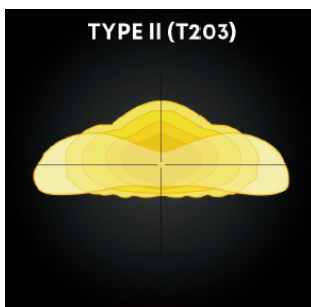

T3

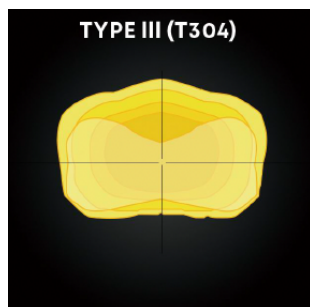

T4

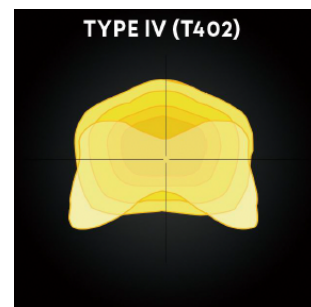



Innovative Design

SUN EATER (SE) was designed to perform. With its unique, bifacial solar panels, **SE** is able to collect both direct and indirect energy, increasing conversion efficiency by up to 40%. This, coupled with the ability to tilt individual LED modules, allows you to achieve the optimum angle for sunlight conversion and light distribution, making it suitable for the varied terrain of parks and hiking tracks. The standard smart microwave sensor allows the light to dim until human movement is detected, when the luminaire will increase the output to create safe passage for passers by, then decrease again to preserve energy and maintain standard light levels. The individually sealed, UV stabilized PC coated SEUOL 5050 LEDs are both safe and efficient, promoting low light decay over time and increased IK rating. Optional extras include bird guard, security cameras, programmable remote control and app, additional surge protection and USB port.

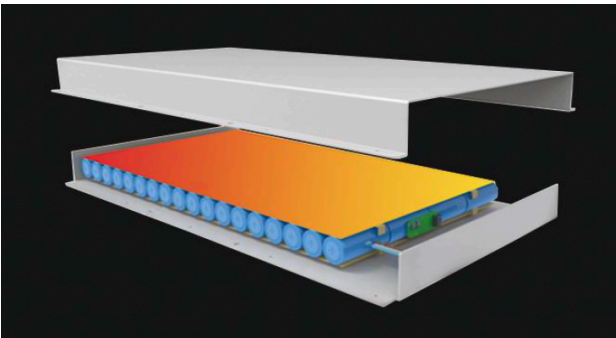

Living its best life

SE was developed to stand the test of time. Housing an ultra high quality Li-ion battery and storing extensive amounts of energy (collected from the bifacial integrated solar panels), it efficiently continues to operate for 5-7 rainy / overcast days on intelligent mode. Protected by integrated heat-sink technology, battery life is extended past industry standards, all while safeguarding LED modules from damage due to overheating. Comfortably achieving the highest possible rating for lumen maintenance (LM90), light output over 52,000hrs reduces by 10% or less (operating at an average temperature of 77°F /25°C).

Durability

Composed of heavy duty die-cast aluminium (EN AC-46100) and rated to operate in temperatures of heat and cold alike, **SE** is the ideal solution for settings where illumination is required but power and access are limited. The housing surfaces are treated with anti-UV thermosetting polyester powder coat and epoxy primer, suitable for extremely corrosive environments with high salt and element exposure. The luminaire and housing are rated IP65 to suit industry standards and all electrical componentry is certified RoHS.

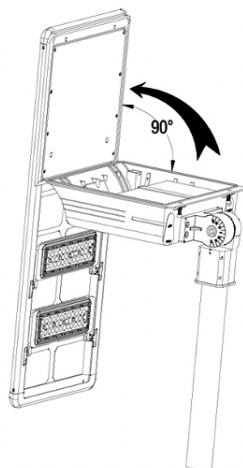

Installation & Access

Without the need for wiring, **SE** is a breeze to install and access for maintenance. An integrated switch on the outer housing allows for quick testing and the field adjustable modules make setting the illumination angle simple (via the tilting LED modules -60°/+60°). The hinged maintenance door is released by removing 2 M8 bolts and tilting the light source panel, allowing access to the battery cell and integrated heat sink which can be worked on confidently without risk of falling parts such as service door covers.

Dimensions & Technical Drawings

Dimensions shown in mm for accuracy, see conversion table below*

10w/15w

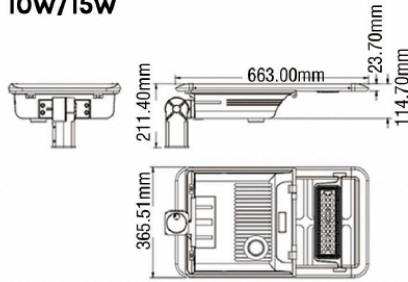

20w/25w

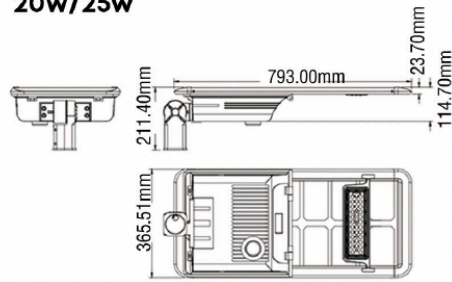

30w/35w

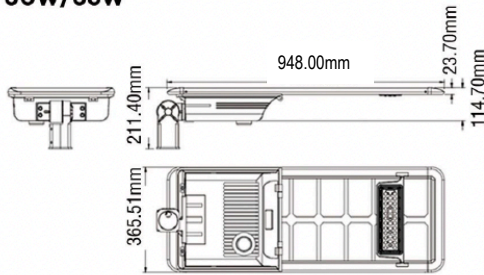

40w/45w

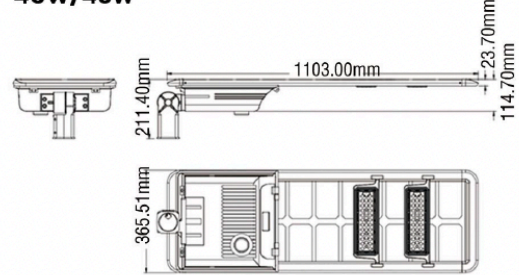

50w

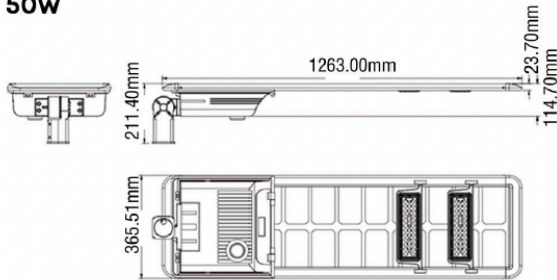

60w

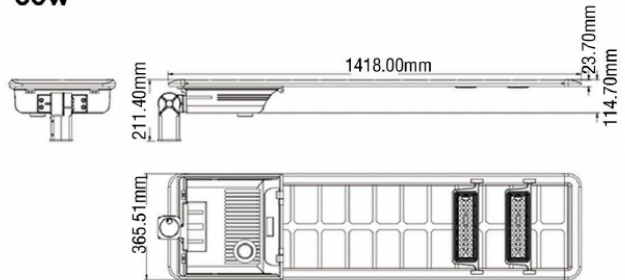

Product Dimensions - conversion table*

	10W / 15W	20W / 25W	30W / 35W	40W / 45W	50W	60W
Product Size mm Inches	663 x 365.51 x 211.4mm 26.10 x 14.39 x 8.32"	793 x 365.51 x 211.4mm 31.22 x 14.39 x 8.32"	948 x 365.51 x 211.4mm 37.32 x 14.39 x 8.32"	1103 x 365.51 x 211.4mm 43.43 x 14.39 x 8.32"	1263 x 365.51 x 211.4mm 49.72 x 14.39 x 8.32"	1418 x 365.51 x 211.4mm 55.83 x 14.39 x 8.32"
Net Weight kg lb	11.49kg 25.33lb	12.86kg 28.35lb	14.89kg 32.82lb	16.5kg 36.38lb	17.61kg 38.80lb	19.66kg 43.34lb

Mounting Options



Type A
Universal Bracket

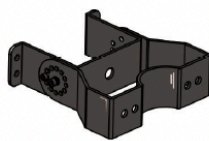

Type B
Wall Mount

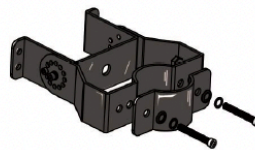

Type C
Round Pole

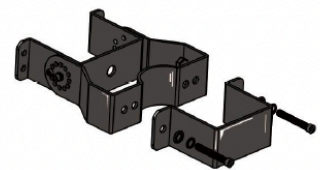

Type D
Square Pole

Specifications**Assembly**

Outer body composed of heavy duty die cast aluminium alloy (EN AC-46100), treated with anti-uv thermosetting polyester powder-coat with 80 micron epoxy primer for extremely corrosive environments. Standard color black, custom painting available upon request. Standard mounting universal slip-fitter to suit tenons of 2 3/8", optional wall, round or square pole mount (tenon adaptors and mounting options can be specified to suit your project upon request). Easy release, under-mounted, hinged service door provides ingress to; Li-ion battery; integrated heat sink; factory label with description of model; QR accessible service tag. Ingress rated to IP65, suitable for wet locations and exposure to elements.

Solar Panel Data

Integrated, bifacial, double crystal photovoltaic solar panels, 18V. Charging time 5.12-6.72hrs. Battery lifespan >2000 times cycle, run time 9-15hrs. Working temperature -10°C to 60°C (-14°F to 122°F), charging temperature -0°C to 45°C (32°F to 113°F). Integrated intelligent controller, rated for operation of 5-7 rainy days in intelligent mode.

Photometric Data

Light source SEOUL 5050, individually enclosed in PC (polycarbonate) treated for UV stabilisation. Efficacy up to 200lm/W with luminous flux range (depending on selected specifications) 2000lm-12000lm total. Dark sky rated (ULOR, inclination of 0°). CCT 3000K, 4000K, 5000K, 5700K, 6500K and color rendering index (CRI) 70Ra (standard), 80Ra, 90Ra. Beam angles T2 (60°*156°), T3 (75°*160°), T4 (78°*153°).

Electrical Data

Wattages available 10W, 15W, 20W, 25W, 30W, 35W, 40W, 45W, 50W, 60W. Input voltage 12-24V Direct Current (DC). Control options include photocell sensor, timing, dimming, intelligent power saving, microwave sensor, LoEa, NB-IoT Smart Lighting Control. High powered LED driver, 4kV (optional) surge protection. All electrical components are RoHS compliant to meet US standards.

Certifications & Compliance

Tested and compliant for L90B10 lifespan of 52,000h at average temp of 25°C. Certified UL / CUL, FCC, DLC, SAA, RCM, CE, RoHS, Factory ISO 9001 and ISO 41001 certified.

Servicing & 10yr Limited Warranty

Luminaires come with QR identifiable service label fixed to the inner side of the service door, allowing access to installation guides, product information and warranty contact. Warranty claims can be made by using the link on the service tag or, by contacting Star LED on +1 423 460 4050, or by emailing info@StarLED.green. For complete 10yr Limited Warranty document, contact us or refer to your original purchase document.

Features

For full list of available features and suitability to your project, please contact your local Sales Representative. Additional features may be available depending on region and market and should be assessed for suitability to the application.

Star LED (HQ)

241 Industrial Park Rd
Mountain City, TN 37683
P +1.423.460.4050
E info@StarLED.green
W www.StarLED.green

T&Cs

All rights reserved 2022 Star LED. Any and all information included in this document may be subject to change at anytime without notice. Star LED does not provide any representation or warranty as to the accuracy or completeness of the information included herein and shall not be held liable for any actions in reliance thereon. This document is not intended as a contract unless indicated and agreed by Star LED.